



Offices in WR1

Sansome Street, Worcester,
Worcestershire, WR1 1UH

£125,000 Starting Bid

Tenure

Freehold

Property features

- ✓ Approximately 721 sq ft (gross internal area)
- ✓ Investment Opportunity
- ✓ Being sold vacant possession

Description

For sale via secure sale online bidding - terms and conditions apply.

A rare opportunity to acquire a freehold retail/commercial premises in the heart of Worcester City Centre, positioned on the established and thriving Sansome Street.

Property Overview -

Address: Sansome Street, Worcester, WR1 1UH – situated in a central location within Worcester’s core shopping and business district.

Tenure: Freehold

Use Class: TBC

Size: Approximately 721 sq ft (gross internal area)

Rental Income - Rental income previously was 12k per annum (potential for up to 18k) - Being sold vacant possession

Property Features -

Prominent town centre frontage on Sansome Street, benefiting from regular pedestrian and vehicle footfall

Flexible commercial interior suitable for retail, showroom, professional or serviced office use (subject to planning/change of use consents)

Nearby occupiers include professional services, advice bureaux and local independent traders, creating a mixed-use commercial environment

Excellent connectivity to Worcester Foregate Street rail station, bus services, and city centre amenities

Price: Starting Bid £125,000

Property Type: Offices

Business Type: Other/Unspecified

Description

A rare opportunity to acquire a freehold retail/commercial premises in the heart of Worcester City Centre



Location

Positioned on the established and thriving Sansome Street.



EPC

This property's energy rating is C.



Tenure

Freehold - Title number WR186161



Additional Information

For further information please contact our office directly on 0191 737 1154, or alternatively via email on commercial@pattinson.co.uk. With regards to viewing subject property, this is to be done strictly by appointment.



GROUND FLOOR
678 sq. ft. (63.0 sq.m.) approx.

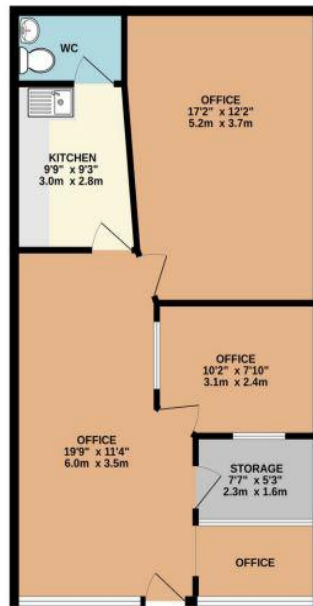

TOTAL FLOOR AREA: 678 sq. ft. (63.0 sq.m.) approx.
Whilst every attempt has been made to ensure the accuracy of the floorplan contained here, measurements of plots, areas, rooms and any other parts are approximate and no responsibility is taken for any error, omission or misstatement. This plan is for illustrative purposes only and should be used as such by any prospective purchaser. The accuracy, contents and appearance of this plan are not intended and no guarantee, as to their quality or efficiency can be given.
Made with Floorplan Studio

Sansome Street, Worcester, Worcestershire, WR1 1UH

Contact your local branch today for more information on this property:

11 Millington Road, Hayes, Middlesex, UB3 4AZ, Tel: 0800 500 3196, www.adanestates.co.uk

These particulars, whilst believed to be accurate are set out as a general outline only for guidance and do not constitute any part of an offer or contract. Intending purchasers should not rely on them as statements of representation of fact, but must satisfy themselves by inspection or otherwise as to their accuracy. No person in this firm's employment has the authority to make or give any representation or warranty in respect of the property.

